

# TPT 50

## TICKETS DISPENSER

8 dot/mm thermal

96 KBytes

32 KBytes of data buffer

Barcode printing

Baud rate up to 38400 bps

7 built-in fonts

24 Vdc power supply

Ticket dispenser aimed at being used in public places fitted with a cutter and a thermal printing mechanism. High autonomy paper; checking and management of keyboard setting. The power supply is single at 24 Vdc.

The TPT50 printer allows the most popular Barcode to be printed. It is ideal for code-cancelling systems, parking metres, game machines, tool receipts, self-service machines, selling applications in general.

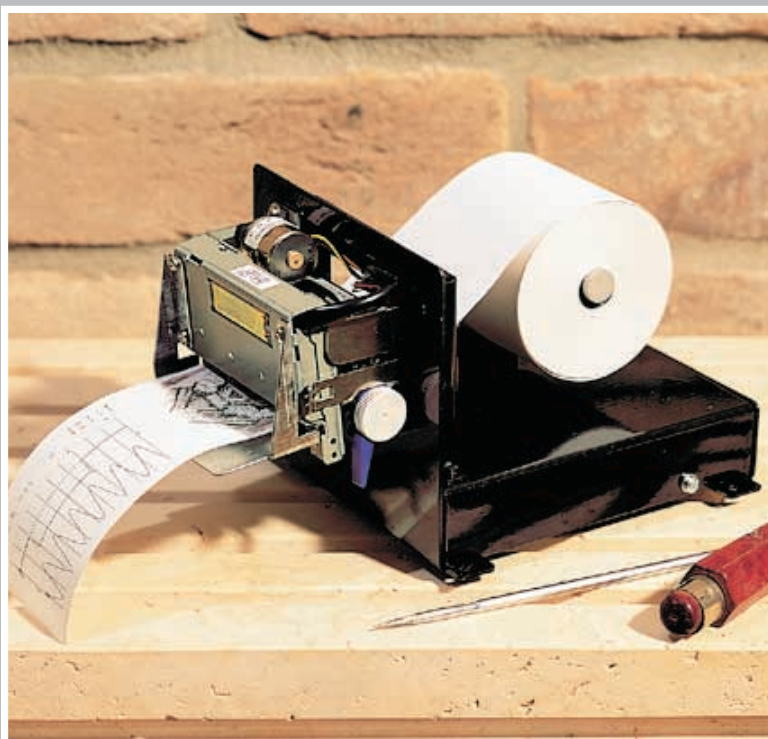

## TECHNICAL SPECIFICATIONS

### Overall dimensions

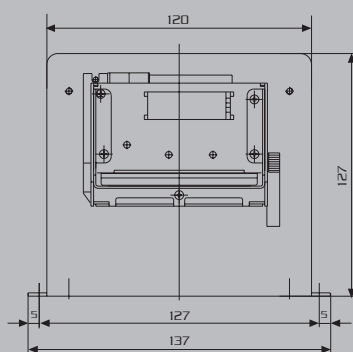

**Power supply**  
The PSP05 power supply with 100-240 Vac is available.

**Barcode**  
TPT50 printer allow the most popular barcode to be printed. The format managed by the printer are the following.

- UPC-A
- UPC-E
- EAN 13
- EAN 8
- CODE 39
- ITF
- CODABAR
- CODE 128

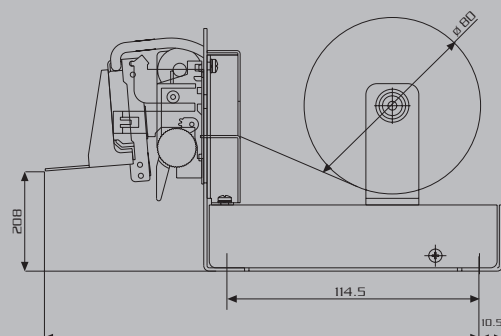

Fissaggio: n°4 fori diam. 3.5 mm

<b>TPT50</b>	Custom emulation		EPSON emulation		
<b>Columns</b>	24	42	32	42	56
<b>Character (LxH mm)</b>	2,2x3	1,3x3	1,8x3	1,3x3	1x3
<b>Print speed</b>	Up to 6,5cm/second (Draft mode)				
<b>Character/second</b>	504	882	672	882	1176
<b>Lines/second</b>	21				
<b>Dots for line</b>	448				
<b>Printing method</b>	Fixed printhead thermal (8 dot/mm)				
<b>Writing method</b>	Straight, 90°, 180°, 270°				
<b>Print format</b>	Normal, double and quadruple height and width, enlarged, negative, underscored, script				
<b>Character font</b>	ASCII Standard, EPSON®, International				
<b>Paper width</b>	60 mm ± 0,5 mm (ø 55 mm max)				
<b>Sensor</b>	End of paper, head open, over temperature				
<b>Buffer</b>	32 KBytes				
<b>Flash memory</b>	256 KBytes (fonts logos firmware)				
<b>Graphic memory</b>	3 logos of 32 KBytes each				
<b>Windriver</b>	Software interface for Windows® 3.x and 95				
<b>Interface</b>	RS232, Centronics switch on board				
<b>Baud rate</b>	From 1200 to 38400 bps				
<b>Cutter</b>	Full/partial				
<b>Power supply</b>	24 Vdc ± 10%				
<b>Power consumption</b>	1,5 A Average, 4,5 A Peak				
<b>MTBF</b>	30km Printed paper				



Dimensions in mm